

LESSON
10-3

Practice B
Area of Composite Figures

Find the area of each polygon.

1.

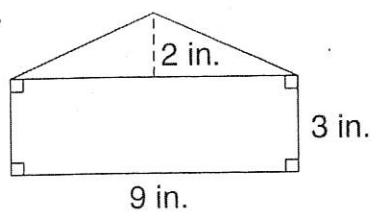

2.

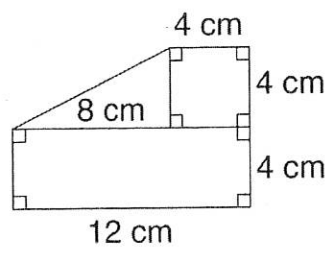

3.

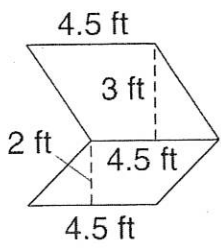

4.

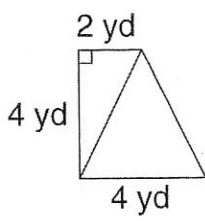

5.

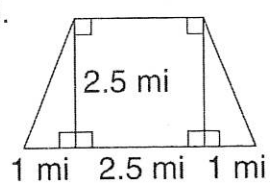

6.

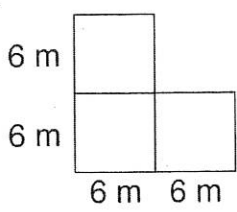

7. Three paintings are shaped like an 8-foot square, a 7-foot by 4-foot rectangle, and a triangle with a 6-foot base and a height of 7 feet. If those paintings are hung together on the outside of a building, how much of the building's wall will they cover altogether?

8. Two diagonals divide a square carpet into 4 congruent triangles. The base of each triangle is 5 feet and the height is 2.5 feet. What is the area of the entire carpet?

LESSON
10-3

Problem Solving
Area of Composite Figures

Write the correct answer.

1. The shape of Nevada can almost be divided into a perfect rectangle and a perfect triangle. About how many square miles does Nevada cover?

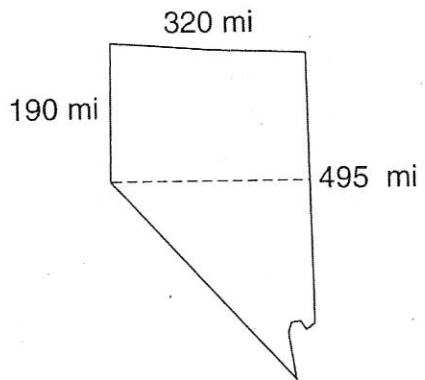

2. The shape of Oklahoma can almost be divided into 2 perfect rectangles and 1 triangle. About how many square miles does Oklahoma cover?

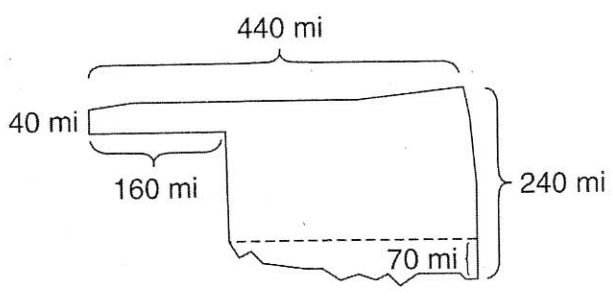

3. The front side of an apartment building is a rectangle 60 feet tall and 25 feet wide. Bricks cover its surface, except for a door and 10 windows. The door is 7 feet tall and 3 feet wide. Each window is 4 feet tall and 2 feet wide. How many square feet of bricks cover the front side of the building?

4. Each side of a square garden is 12 meters long. A hedge wall 1 meter wide surrounds the garden. What is the area of the entire garden including the hedge wall? How many square meters of land does the hedge wall cover alone?

Circle the letter of the correct answer.

5. A figure is formed by a square and a triangle. Its total area is 32.5 m^2 . The area of the triangle is 7.5 m^2 . What is the length of each side of the square?
- A 5 meters C 15 meters
B 25 meters D 16.25 meters

6. A rectangle is formed by two congruent right triangles. The area of each triangle is 6 in^2 . If each side of the rectangle is a whole number of inches, which of these could not be its perimeter?
- F 26 inches H 24 inches
G 16 inches J 14 inches